

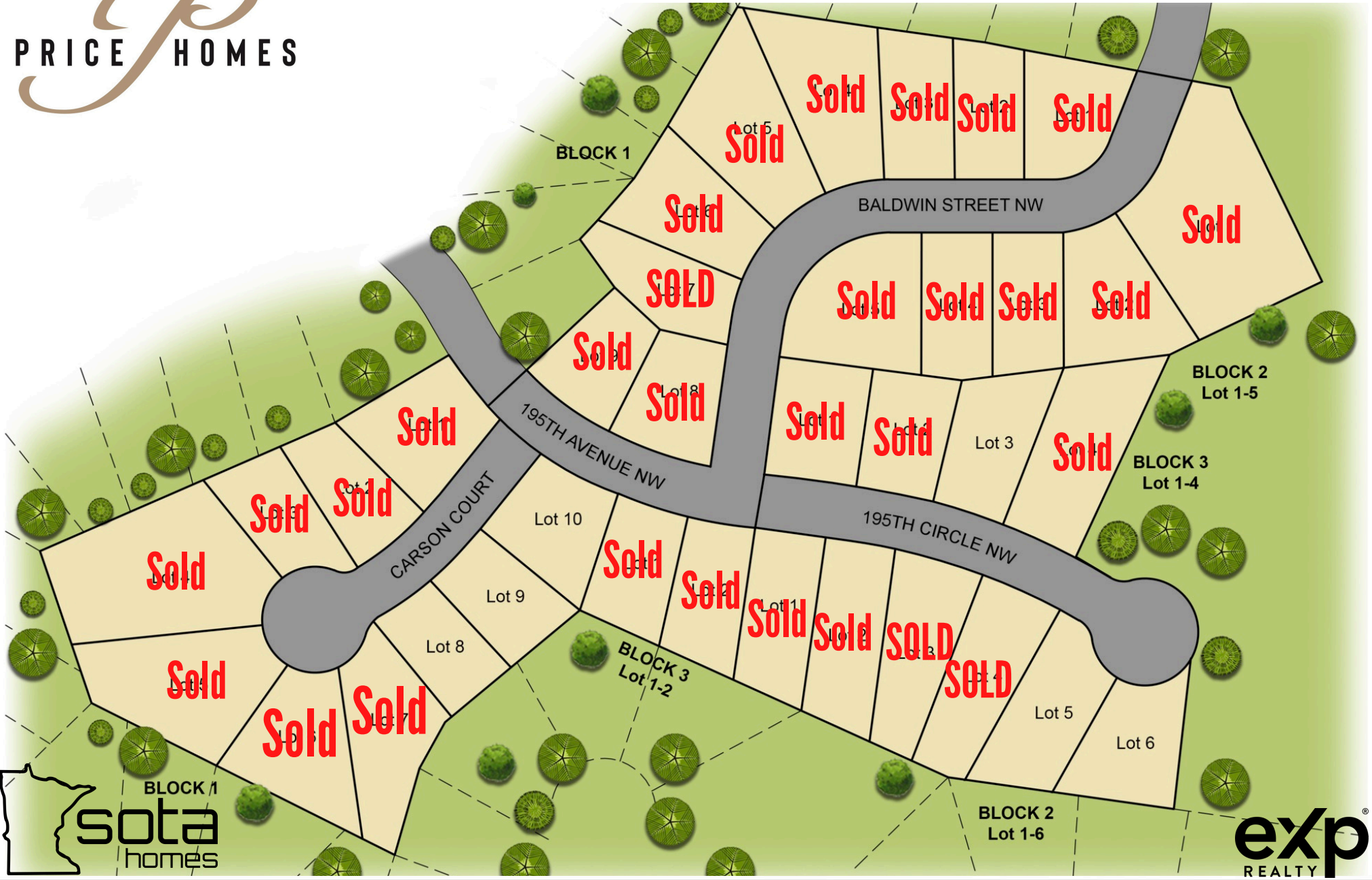

# Hillside Estates 11th & 12th Addition



[www.sotahomes.com](http://www.sotahomes.com)

\*\*Information is deemed to be reliable but not guaranteed. Lot holds change daily\*\*

# Hillside Estates 11th & 12th Addition

	<u>Block</u>	<u>Lot</u>	<u>Pricing</u>	<u>Acres</u>	<u>Style</u>
11th Add.	2	3	\$90,000	0.29	FBWO
	1	1	\$96,000	0.38	FB
	1	2	\$98,000	0.29	FB
	1	3	\$96,000	0.29	FB
	1	4	\$96,000	0.75	SEWO
	1	5	\$96,000	0.53	SEWO
	1	6	\$96,000	0.40	SEWO
	1	7	\$96,000	0.40	SEWO
	1	8	\$94,000	0.28	FBWO
	1	9	\$94,000	0.28	FBWO
	1	10	\$95,000	0.29	FBWO

*FB=Full Basement*

*SEWO=Split Entry Walkout*

*FBWO=Full Basement Walkout*



# Hillside Estates 12th Addition

<u>Block</u>	<u>Lot</u>	<u>Pricing</u>	<u>Acres</u>	<u>Style</u>
2	1	\$94,000	0.34	FBWO
2	2	\$94,000	0.38	FBWO
2	3	\$94,000	0.40	SEWO
2	4	\$96,000	0.42	SEWO
2	5	\$96,000	0.40	FB
2	6	\$104,000	0.34	FB
3	1	\$93,000	0.33	FBWO
3	2	\$93,000	0.30	FBWO
3	3	\$102,000	0.36	FBWO
3	4	\$104,000	0.48	FBWO

*FB=Full Basement*

*SEWO=Split Entry Walkout*

*FBWO=Full Basement Walkout*

